

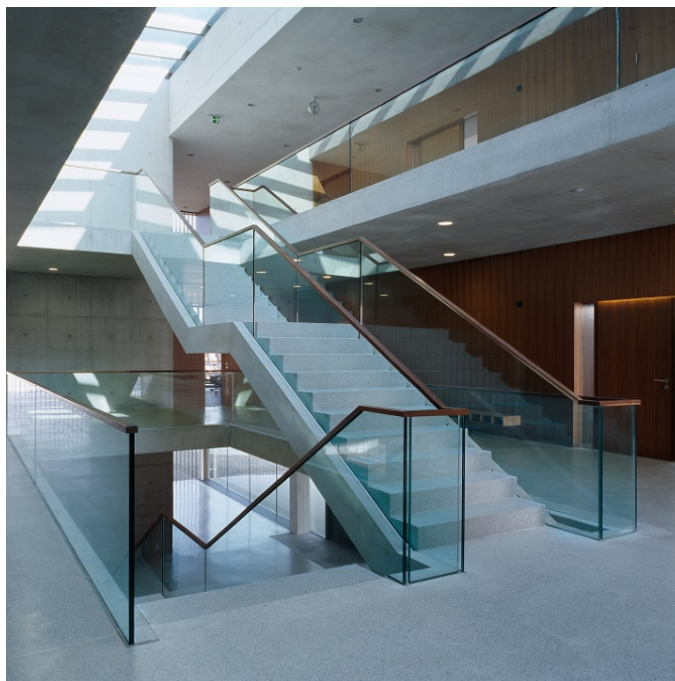

**REFERENCE OBJECT: COLLÈGE DU MARAIS DU BILLET, CH-1033
LAUSANNE**



REFERENCE OBJECT: COLLÈGE DU MARAIS DU BILLET, CH-1033 LAUSANNE



Products

Reference Object

Bureau of Architecture

Glas

Photographer

- SILVERSTAR SELEKT 74/42 und 74/42 T

Collège du Marais du Billet
Route de Lausanne 2C
1033 Chesaux-sur-Lausanne

Graeme Mann & Patricia Capuca Mann

Fassade aus SILVERSTAR SELEKT und SILVERSTAR ENplus.
Treppengeländer aus Verbundsicherheitsglas.

Thomas Jantscher